

AMENDMENT 81-02

**SEQUOIA FIELD
LAND USE AND PUBLIC
BUILDINGS ELEMENTS**

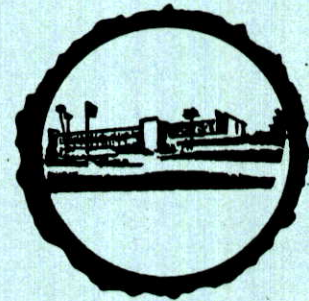

**Approved: Tulare County Planning Commission
Resolution 5678 - June 24, 1981**

**Adopted: Tulare County Board of Supervisors
Resolution 81-1873 - September 29, 1981**

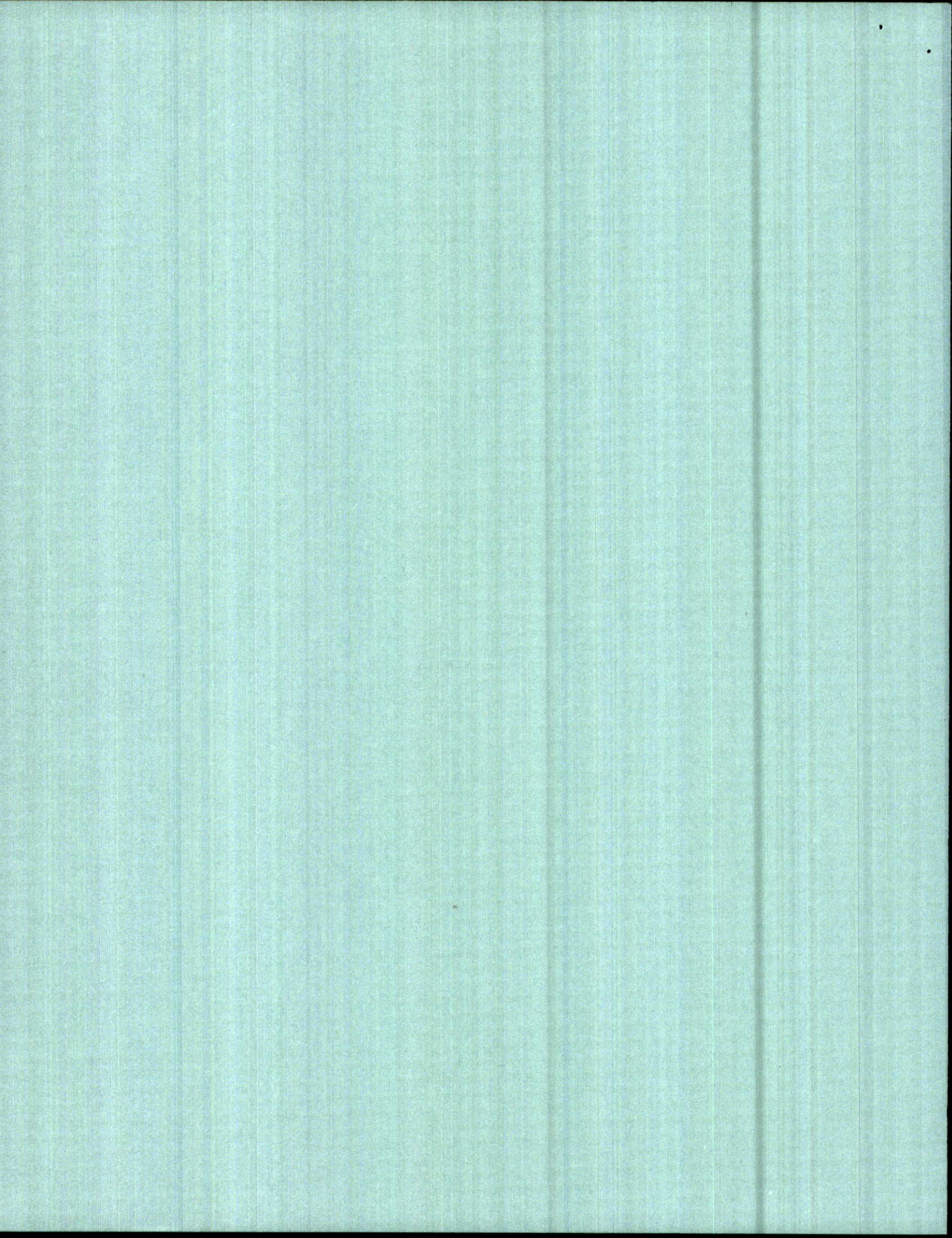

AMENDMENT TO THE
TULARE COUNTY AREA GENERAL PLAN
LAND USE AND PUBLIC BUILDINGS ELEMENTS
SEQUOIA FIELD FACILITY
GPA 81-02

I. INTRODUCTION

This document amends the Land Use Element, including the 1975 Rural Valley Lands Plan, and the Public Buildings Element of the Tulare County General Plan.

II. SUPERCEDEURE

This amendment supercedes the 1964 adopted Land Use Plan for the Sequoia Field area to the limited extent of designating 320 acres, located southeast of the intersection of Avenue 368 and Road 112 as a major public facility. This amendment also supercedes the 1975 Rural Valley Lands Plan (RVLP) in that the policies and procedures set forth in the RVLP are no longer applicable to the Sequoia Field facility. In addition, this amendment supercedes the 1972 Environmental Resources Management Element in that the Sequoia Field property will no longer be shown as the site of the "Sequoia County Home".

III. MODIFICATION TO ADOPTED ELEMENTS

Land Use Element:

A major public facility area of 320 acres is designated for the area south of Avenue 368 and east of Road 112 replacing an "Agricultural" designation on the Plan map of the Land Use Element of the General Plan.

The designation of the area for "major public facilities" establishes County policy for use of the property and enables the County to proceed with plans for expanding public use of the site. In particular, current plans call for development of a new County Correctional Center on a portion of the site. It also means that all 320 acres of the site will be reserved for

"public use". However, it is not intended that this designation will limit the ability of the County to allocate the site for non-public use as long as such non-public use is consistent with the policies of the General Plan and is not harmful to the environment.

Public Buildings Element:

The plans for the Tulare County Correctional Center at Sequoia Field contained in the "Final Facility Program and Site Master Plan" (November 18, 1980) are added to the Public Buildings Element of the Tulare County General Plan. In addition, a general layout of planned use areas of the Sequoia Field property is hereby adopted as a part of the Public Buildings Element.

IV. IMPLEMENTATION STRATEGIES

Zoning:

To implement the proposed change in land use from "Agricultural" to "Public" no change in zoning is required. This area is zoned "AE-40" (Exclusive Agriculture) and most public uses are permitted in the AE-40 Zone. It is proposed, however, that the Zoning Ordinance be amended by adding jails or correctional facilities as special uses in the AE-40 Zone, provided that no permit is required to locate a correctional institution as long as it is in conformance with the Public Buildings Element of the Tulare County General Plan.

Construction Phasing:

The construction time-table for development of the Correctional Center is dependent upon the availability of State grant funds. However, a schedule for phasing of construction and site development based on availability of State funds beginning FY 81-02 is included in the Final Facility Plan.



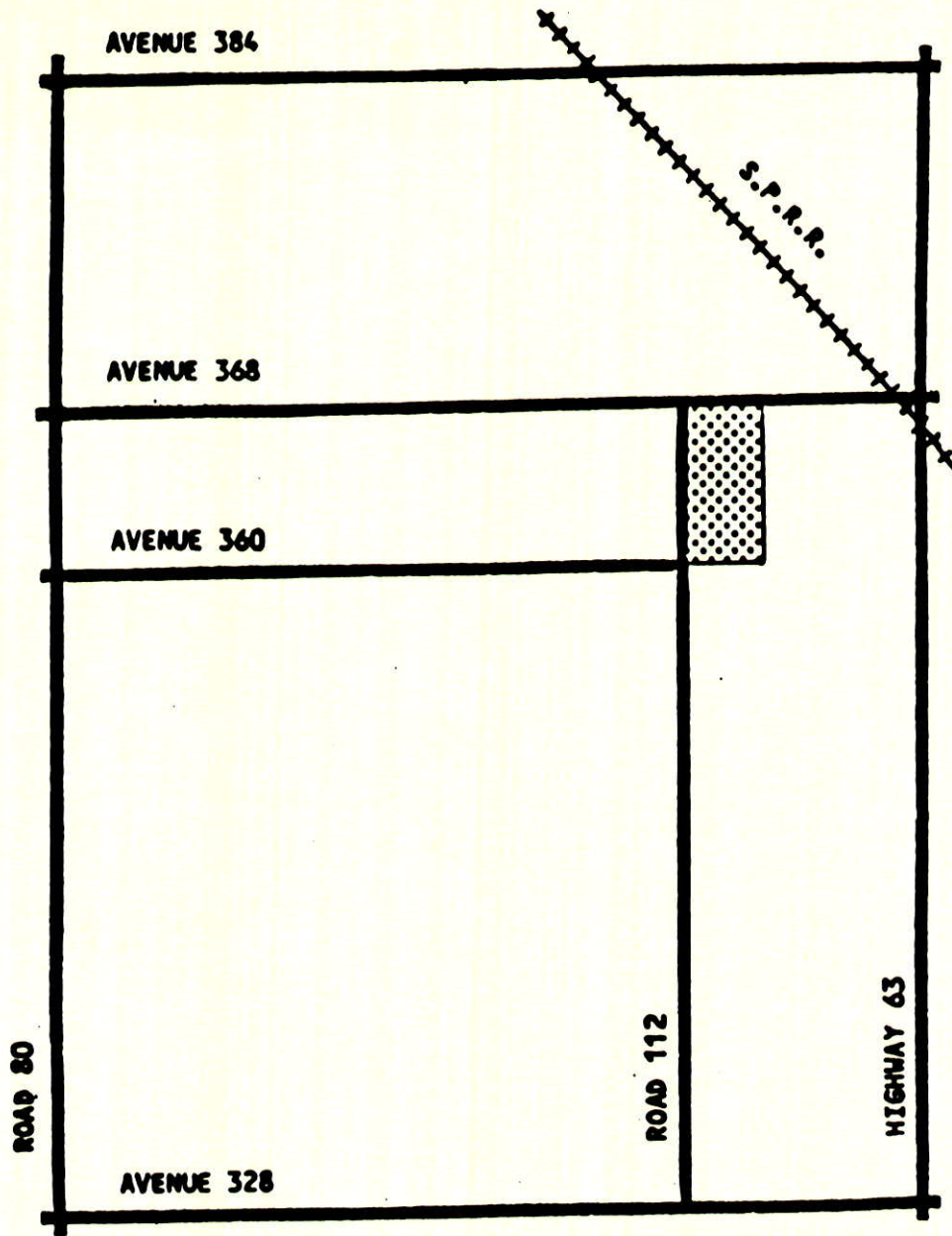

OO SEQUOIA FIELD OO

TULARE COUNTY AREA GENERAL PLAN
 LAND USE ELEMENT
 AMENDMENT 81-02

APPROVED BY TULARE COUNTY PLANNING COMMISSION
 RESOLUTION NO. 8078
 CERTIFIED: *[Signature]* 8/24/81
 SECRETARY DATE

ADOPTED BY TULARE COUNTY BOARD OF SUPERVISORS
 RESOLUTION NO. 81-1873
 CERTIFIED: *[Signature]* 8/29/81
 CHAIRMAN DATE

PREPARED BY TULARE COUNTY PLANNING DEPARTMENT

POR. OF THE E. 1/2
 OF SECTION 13
 T. 17 S. R. 26 E.

-  MAJOR PUBLIC AND SEMI-PUBLIC FACILITIES
-  AGRICULTURAL



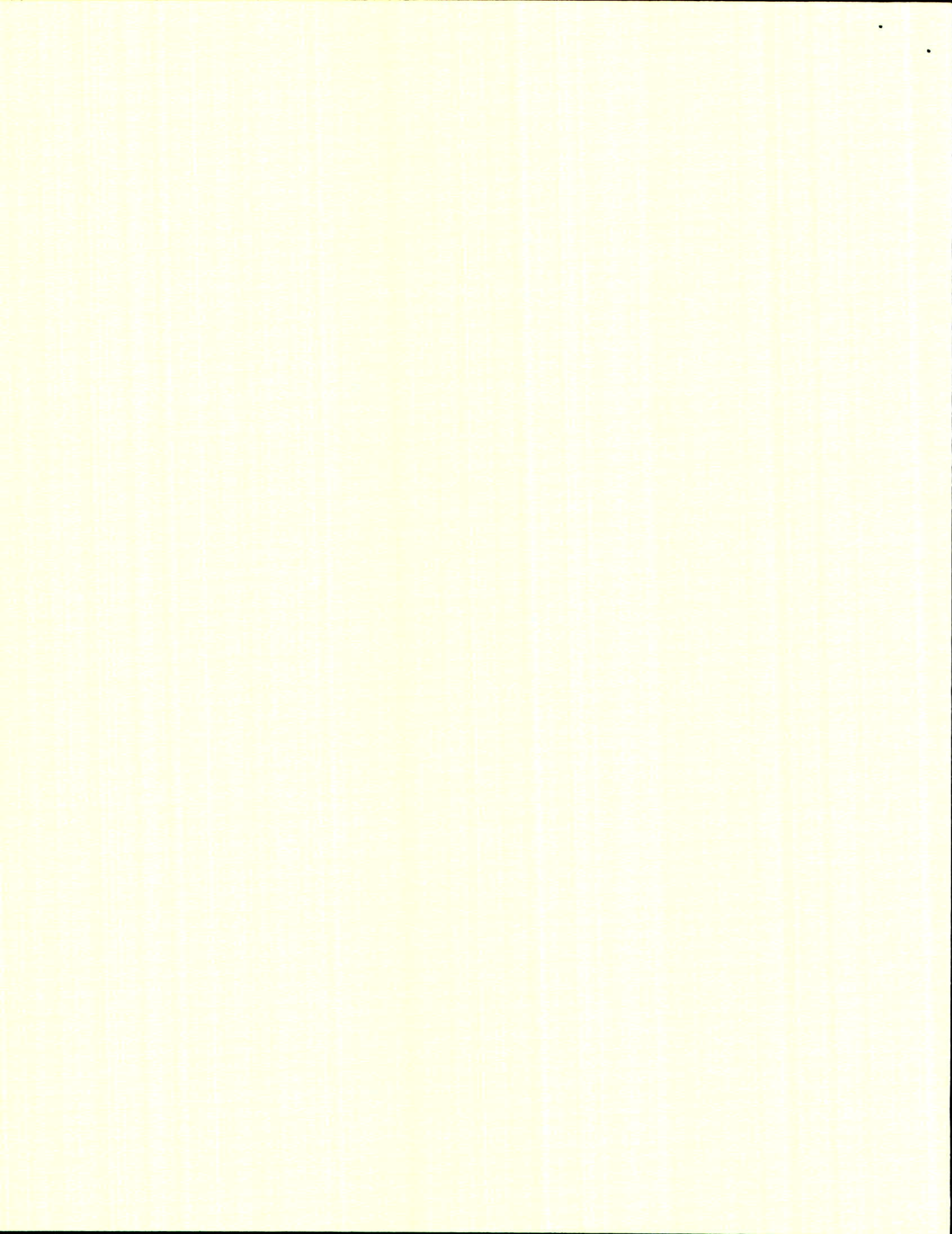

RECOMMENDED SITE

NEW CORRECTIONAL FACILITY

40 Acres

AGRICULTURAL FIELDS OR LAND FILL

EXISTING SWINE FACILITY

ROAD 112

TOTAL SITE: 320 ACRES

EXISTING AIRPORT

ROBERT K. MYERS BOYS RANCH

PROPOSED LOCATION OF SWINE FACILITY IF IT IS TO BE MOVED

EXISTING TULARE COUNTY CORRECTIONAL CENTER

AVE. 360

OO SEQUOIA FIELD FACILITY OO

TULARE COUNTY AREA GENERAL PLAN PUBLIC BUILDINGS ELEMENT AMENDMENT 81-02

APPROVED BY TULARE COUNTY PLANNING COMMISSION
 RESOLUTION NO. 8878
 CERTIFIED: *[Signature]* 6/24/81
 SECRETARY DATE

ADOPTED BY TULARE COUNTY BOARD OF SUPERVISORS
 RESOLUTION NO. 81-1873
 CERTIFIED: *[Signature]* 9/29/81
 CHAIRMAN DATE

PREPARED BY TULARE COUNTY PLANNING DEPARTMENT

POR. OF THE E. 1/2 OF SECTION 13 T. 17 S. R. 24 E.



SCALE IN FEET
0 200 400

